



RayWhite

**136A Pine Avenue MILDURA VIC**

3 2 2

Damian Portaro Principal & Managing Director proudly present for sale this modern inner-city residence, set to go under the hammer in one of Mildura's most tightly held lifestyle pockets.

Built in 2016, this stylish and low-maintenance home continues to deliver exactly what so many buyers are chasing, quality modern living, a secure and manageable allotment, and the convenience of having the CBD, cafés, schools and shopping all within easy reach. Whether you are a professional couple, downsizer, investor or lifestyle-focused buyer, this is the kind of property that remains highly sought after for very good reason.

Inside, the home offers a thoughtful and functional floorplan

[For full version visit the website](https://www.whydiamian.com)

**Type** : House  
**Price** : \$775,000 - \$852,000  
**Land Size** : 287 sqm  
**View** : <https://www.whydiamian.com/sale/vic/north-western/mildura/residential/house/8683211>

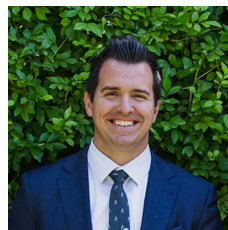

**Damian Portaro**  
0419 838 743



**Katrina Wootton**  
(03) 5021 9500

Siteplan

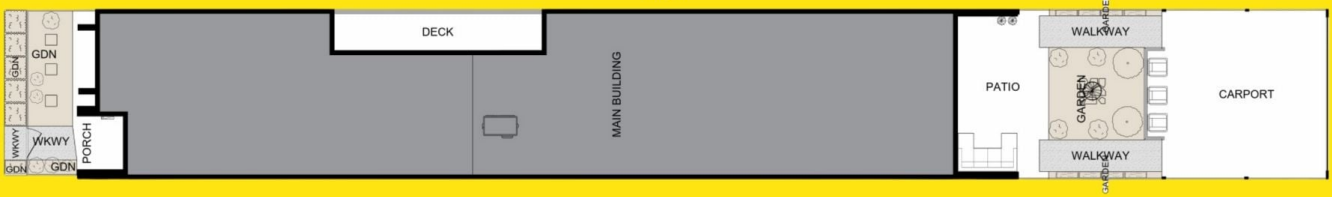

Floorplan



DISCLAIMER: This siteplan is for illustrative purposes only and may not be to scale. All boundaries, areas, dimensions, fixtures and positioning are approximate and subject to change. Landscaping and external features are indicative only. Interested parties should make their own enquiries and obtain independent advice to verify any information. © Ray White Mildura. All rights reserved. Unauthorised use or reproduction is prohibited.